

- Warehouse -
- Light Industrial -
- with Office -

5900 - 10,000 sq. ft. total
 (1900 - 2600 sq.ft. finished office)
 Will divide warehouse

Looking for...

- Easy Access?** 4-lane U.S. 30 frontage
- Visibility?** ~ 30,000 cars daily
- Loading Docks?** Semi- & Drive-in
- Plenty of Parking?** Paved & Well-lit lot

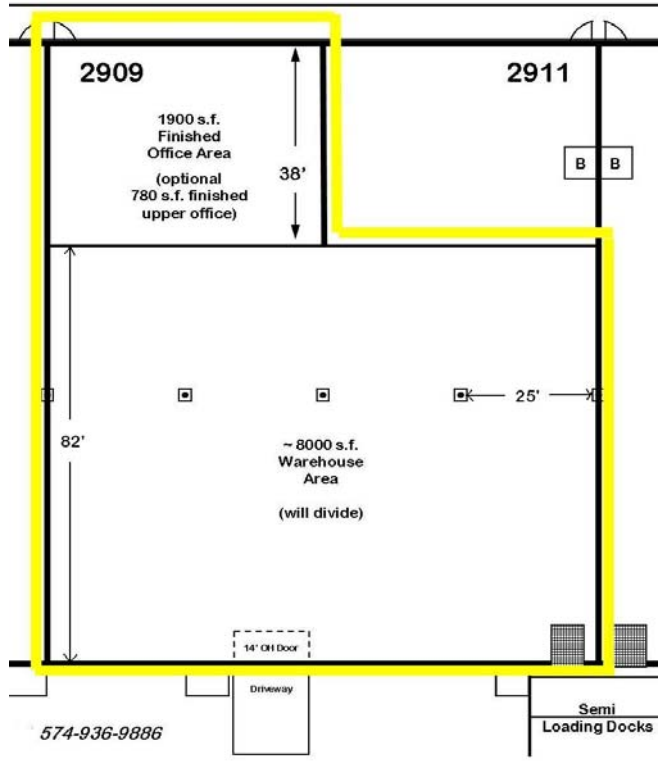

Located on the Northwest Corner of
U.S. 30 and Pine Road
 Plymouth, Indiana

Contact: *David Miller*

Cell: 574-936-9886
 Fax: 574-935-0402
 Email: dmiller@vancodevelopment.com

For a **FREE**
 Market Profile Report and
 other Plymouth Demographics
 visit our Website:
www.vancodevelopment.com



VANCO DEVELOPMENT, LLC

* HERITAGE PARK * PINE CREEK CENTER * VAN VACTOR PARK *